

Cutlass Fasteners, Inc.

83 Vermont Ave., Unit 6, Warwick, RI 02888
 Tel: (401) 732-6333 Fax: (401) 732-6336
 cutlass-studwelding.com

Stud Welding...

- Fasteners
- Equipment
- Service

T-SLOT RECTANGULAR STUDS

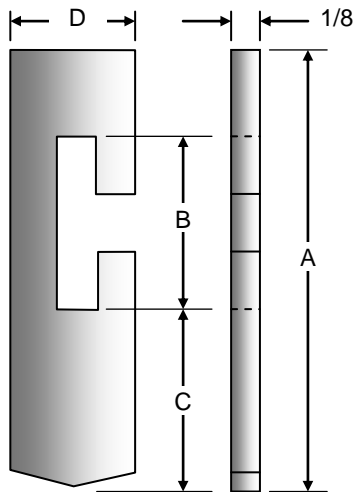

| MATERIAL | PART NO. | A | B | C | D | FERRULE |
|-----------------|------------|-------|-------|-------|-----|---------|
| MILD STEEL | 3701-3044 | 1.3/8 | 1/2 | 5/8 | 3/8 | RE-0412 |
| STAINLESS STEEL | 3702-3044 | | | | | |
| MILD STEEL | 3701-3052 | 1.5/8 | | 7/8 | | |
| STAINLESS STEEL | 3702-3052 | | | | | |
| MILD STEEL | 3701-3068 | 2.1/8 | | 1.3/8 | | |
| STAINLESS STEEL | 3702-3068 | | | | | |
| MILD STEEL | 3701-4044 | 1.7/8 | 1.0 | 5/8 | 5/8 | RE-0420 |
| STAINLESS STEEL | 3702-4044 | | | | | |
| MILD STEEL | 3701-4052 | 2.1/8 | | 7/8 | | |
| STAINLESS STEEL | 3702-4052 | | | | | |
| MILD STEEL | 3701-4068 | 2.5/8 | | 1.3/8 | | |
| STAINLESS STEEL | 3702-4068 | | | | | |
| MILD STEEL | 3701-40100 | 3.1/8 | 1.7/8 | | | |
| STAINLESS STEEL | 3702-40100 | | | | | |

1/4 X 1.1/4 RECTANGULAR STUDS

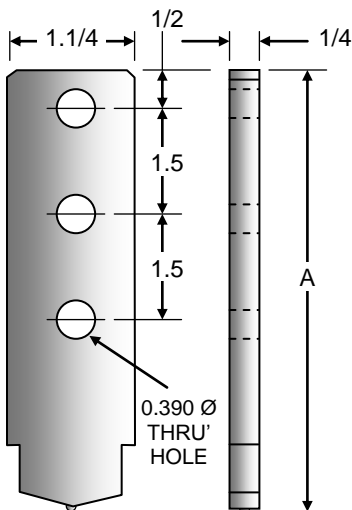

| MATERIAL | A | NO. OF HOLES | PART NO. | FERRULE |
|------------|-------|--------------|----------------|---------|
| MILD STEEL | 2.1/8 | 1 | 144-0840-068-2 | RE-0824 |
| | 3.0 | 1 | 144-0840-096-2 | |
| | 4.0 | 2 | 144-0840-128-2 | |
| | 5.0 | 2 | 144-0840-160-2 | |
| | 6.0 | 3 | 144-0840-192-2 | |
| | 7.0 | 3 | 144-0840-224-2 | |
| | 8.0 | 4 | 144-0840-256-2 | |

"A" dimension is length before weld. Studs will be approximately 1/8" shorter after weld.

Non-standard lengths may be available by special order....minimum order quantities may apply.