

Cutlass Fasteners, Inc.

83 Vermont Ave., Unit 6, Warwick, RI 02888
 Tel: (401) 732-6333 Fax: (401) 732-6336
 cutlass-studwelding.com

Stud Welding...

- Fasteners
- Equipment
- Service

ARC FT WELD STUDS

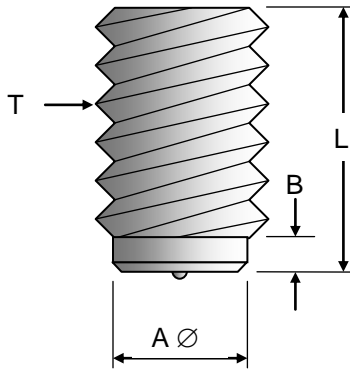

T (Thread)	A Ø	B	Std. Ferrule	Low Ferrule
10-24, 10-32	0.163	1/8"	FB-06	LP-06
1/4-20	0.215	1/8"	FB-08	LP-08
5/16-18	0.275	1/8"	FB-10	LP-10
3/8-16	0.334	1/8"	FB-12	LP-12
1/2-13	0.448	1/8"	FB-16	LP-16
5/8-11	0.562	3/16"	FB-20	LP-20
3/4-10	0.680	3/16"	FB-24	LP-24

Thread Size	Material	Part No. Prefix	L (Length ± 0.015")													
			3/4	7/8	1.0	1.1/8	1.1/4	1.3/8	1.1/2	1.5/8	1.3/4	2.0	2.1/8	2.1/2	3.0	4.0
10-24 UNC	Mild Steel	3001-	0524	0528	0532	0536	0540	0544	0548	0552	0556	0564				
	Stainless	3002-	0524	0528	0532	0536	0540	0544	0548	0552	0556	0564				
10-32 UNF	Mild Steel	3011-	0524	0528	0532	0536	0540	0544	0548	0552	0556	0564				
	Stainless	3012-	0524	0528	0532	0536	0540	0544	0548	0552	0556	0564				
1/4-20 UNC	Mild Steel	3001-	0824	0828	0832	0836	0840	0844	0848	0852	0856	0864	0868	0880	0896	
	Stainless	3002-	0824	0828	0832	0836	0840	0844	0848	0852	0856	0864	0868	0880	0896	
5/16-18 UNC	Mild Steel	3001-	1024	1028	1032	1036	1040	1044	1048	1052	1056	1064	1068	1080	1096	
	Stainless	3002-	1024	1028	1032	1036	1040	1044	1048	1052	1056	1064	1068	1080	1096	
3/8-16 UNC	Mild Steel	3001-	1224	1228	1232	1236	1240	1244	1248	1252	1256	1264	1268	1280	1296	12128
	Stainless	3002-	1224	1228	1232	1236	1240	1244	1248	1252	1256	1264	1268	1280	1296	12128
1/2-13 UNC	Mild Steel	3001-		1628	1632	1636	1640	1644	1648	1652	1656	1664	1668	1680	1696	16128
	Stainless	3002-		1628	1632	1636	1640	1644	1648	1652	1656	1664	1668	1680	1696	16128
5/8-11 UNC	Mild Steel	3001-			2032	2036	2040	2044	2048	2052	2056	2064	2068	2080	2096	20128
	Stainless	3002-			2032	2036	2040	2044	2048	2052	2056	2064	2068	2080	2096	20128
3/4-10 UNC	Mild Steel	3001-				2436	2440	2444	2448	2452	2456	2464	2468	2480	2496	24128
	Stainless	3002-				2436	2440	2444	2448	2452	2456	2464	2468	2480	2496	24128

Part number example....1/4-20 X 1.1/4 SS FT ARC STUD....3002- 0840

Studs 1/2" diameter and below will be 1/8" shorter after weld. Studs 5/8" diameter and larger will be 3/16" shorter after weld. All part numbers refer to length before weld.

Non-standard diameters and/or lengths are available by special order....minimum order quantities may apply.